

Product Information



Xclude™ Contamination Exclusion

Xclude™ High Humidity Check Valve Breather

Ideal solution to protect against moisture and particulate contamination in low-flow applications with intermittent operations



Typical Industries

- Wind Energy
- Pulp & paper
- Aviation
- Storage
- Manufacturing
- Petrochemical

Applications

- Gearboxes
- Low-flow
- High-humidity
- Washdown

Charts & Graphs



Airflow

LEXHHCV1-66

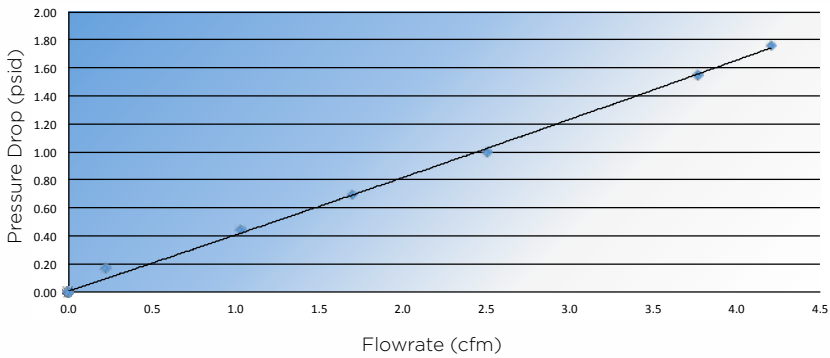

LEXHHCV1-122

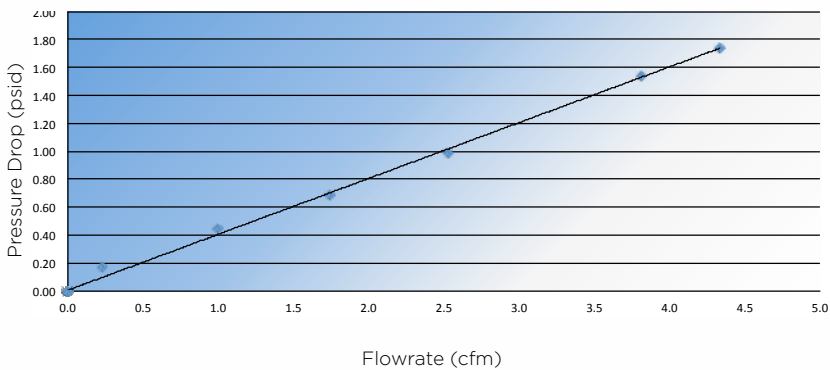

LEXHHCV1-188

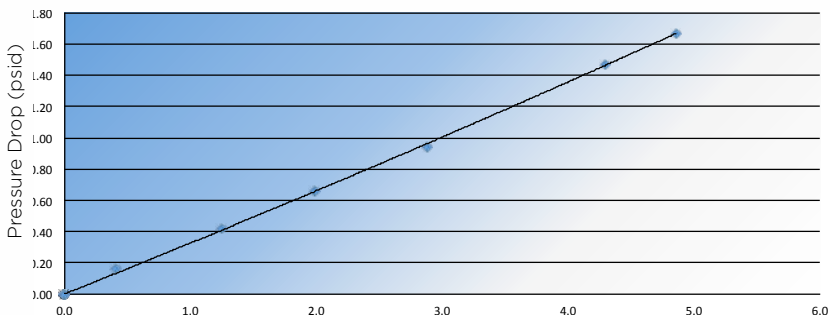

Standard Sizes

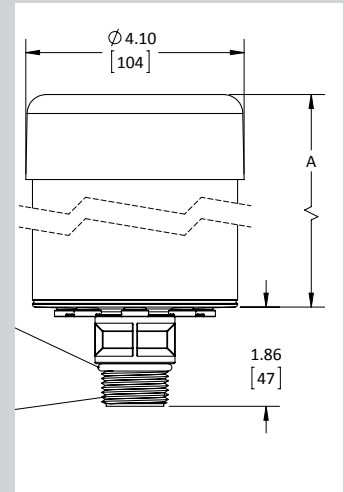

LEXHHCV1-66 4.13

LEXHHCV1-122 6.13

LEXHHCV1-188 8.13

Miniature Sizes

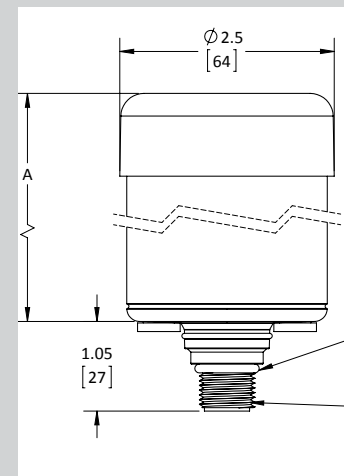

LEXHHCV375-13 2.824

LEXHHCV375-28 4.307

Charts & Graphs



Materials & Components

Filter housing: Polycarbonate, nylon, polypropylene, Buna-N, silicone
Filter media: Polyurethane, polyester
Hydrophilic media: Silica gel

Filter Efficiency

3 μ absolute ($\beta_3 \geq 200$)

Recommended Temperature Range

-20°F to 200°F
-29°C to 93°C

Chemical Compatibility

Recommended:

- All gear oils
- Most hydraulic fluids
- Mineral & synthetic oil

Not recommended:

- Phosphate ester
- Hydrogen sulfide
- Sulfuric acid
- Highly alkaline cleaners

Sizing Recommendations

Model	Max. Airflow at 1psid	Recommended Max. Volume
		Gearbox/ Storage Tank
LEXHHCV375-13	1.45cfm/41lpm	15gal/57L
LEXHHCV375-28	1.45cfm/41lpm	35gal/132L
LEXHHCV1-66	2.44cfm/69lpm	200gal/757L
LEXHHCV1-122	2.48cfm/70lpm	350gal/1325L
LEXHHCV1-188	2.98cfm/84lpm	500gal/1893L

Water Adsorption Capacity

Size	Maximum Water Retention
LEXHHCV375-13	23ml / 0.8 fluid oz
LEXHHCV375-28	50ml / 1.68 fluid oz
LEXHHCV1-66	118ml / 4 fluid oz
LEXHHCV1-122	220ml / 7.45 fluid oz
LEXHHCV1-188	353ml / 11.3 fluid oz

Dimensions & Connections

Model	Connection	Unit Height	Unit Width
LEXHHCV375-13	3/8" Multi-Fit (NPT, BSPP, BSPT)	3.90in	2.5in
		9.9cm	6.4cm
LEXHHCV375-28	3/8" Multi-Fit (NPT, BSPP, BSPT)	5.351in	2.5in
		13.5cm	6.4cm
LEXHHCV1-66	1" Multi-Fit (NPT, BSPP, NPSM)	6in	4.1in
		15.6cm	10.2cm
LEXHHCV1-122	1" Multi-Fit (NPT, BSPP, NPSM)	8in	4.1in
		20.6cm	10.2cm
LEXHHCV1-188	1" Multi-Fit (NPT, BSPP, NPSM)	10in	4.1in
		25.7cm	10.2cm

Overview



By the Numbers

1—Recessed Check-Valves

High-quality umbrella check-valves that won't clog or stick are recessed underneath the unit for added protection from washdown environments. Check-valves isolate equipment from ambient conditions, prolonging breather life.

2—Integrated Nylon Standpipe

The integrated standpipe provides excellent vibration resistance and dissipates impact throughout the unit, eliminating weak points. It also allows even airflow distribution throughout the unit, eliminating inaccurate readings of desiccant saturation.

3—Resilient Polycarbonate Body

Shock-absorbing, clear casing provides reliable service and easy maintenance.

4—Filter Element

Polyester filter element removes airborne contamination to 3-micron absolute. Unique loops allow particles to release during system exhalation, helping to increase breather life.

5—Water Adsorbent

Silica gel adsorbs water from incoming air and can hold up to 40% of its weight. Condition is indicated by change of color from blue to light pink.

6—Secondary Filter Element

Second polyester filter element protects against migration of desiccant dust, providing maximum efficiency.

7—Foam Pad

Foam filter captures any oil mist and disperses incoming air evenly over filtration and drying areas.

8—Threaded Mounting

Easily replaces standard filler/breather cap with multi-fit connection or one of several adapters.

How It Works

This breather unit replaces the standard dust cap or OEM breather cap on equipment. Check-valves on the bottom of the unit isolate the system until equipment needs to breathe. As air is drawn into equipment through the breather, the layered filter elements remove particulates while the desiccant beads strip harmful moisture.

While in service or during shutdown, the desiccant beads attract moisture from inside the equipment reservoir, actively drying the equipment.

